

CONAIR TRUESMOOTH BEAUTY PEN

多功能美容筆

true smooth



INSTRUCTION
BOOKLET
使用說明

CONAIR®

C8760RGH

TrueSmooth美容筆是您塑造完美比堅尼線的必備小幫手。

配備3款轉換頭，讓您每日保持美態或緊急修剪之用。

旋轉剃刀能溫柔有效地去除唇邊、下巴、面頰及其他幼嫩部位的毛髮，讓肌膚重拾光滑。

產品特點

- 電動修剪器
- 旋轉剃刀更快捷、更緊貼肌膚
- 眉毛修剪器能精準塑形
- 精確修毛器能全面修整毛髮
- 配備修剪梳
- 配備眉毛梳
- 配備收納小袋
- 配備剃刀頭套
- 乾濕兩用。可於沐浴時使用
- 配備一枚AA電池

使用說明

皮膚處理

使用產品前：請確保皮膚清潔乾淨。切勿搽上任何潤膚霜或潤膚液等產品。

電池使用

TRUESMOOTH美容筆需配以一枚AA鹼性電池（1.5伏特）使用。如需置入或更換電池，除下美容筆下端的外殼則可見電池盒。除下時，一手緊握美容筆上端，另一手緊握下端並向下推。按兩極方向正確置入電池（建議使用鹼性電池，以保持產品良好運作及耐用）。若一段時間內不使用產品或電池電量耗盡，請將電池拆除以確保產品更耐用。

開始使用

TRUESMOOTH美容筆配備3款轉換頭，保持您的肌膚嫩滑。

- 更換轉換頭前，請先確保美容筆關閉。
- 將筆頭向右旋轉至▼及▲兩個三角標誌接合。
- 除下筆頭套，裝上所需的轉換頭並向左旋轉至▼及○接合。

使用說明

- 向左轉動電池盒外殼以解鎖。
- 按電池極向置入一枚AA電池，套回電池盒外殼並向右轉動直至○及▲接合以上鎖，然後繼續向右轉動。當▲及▲接合時則可開始使用。
- 使用完畢後，轉動電池盒外殼至▲及○接合則可關閉電源。

使用前

- 用於身體其他部位前，請先於腿或手臂作小範圍測試。

- 若皮膚產生過敏反應，請即停止使用。
- 切勿用於敏感或過敏皮膚上。

旋轉剃刀的使用

剃刀若有損毀，切勿使用，以免受傷。本產品可作乾濕兩用。

脫毛程序

- 換上剃刀頭。
- 向右轉動電池盒外殼至I及▲接合則可開始使用。
- 將刀鋼貼著皮膚，以逆毛方向慢慢以打圈方式移動。
- 不要過分大力推動以免令皮膚敏感或刀鋼損毀。
- 脫毛後皮膚或變得敏感，請先於一小部分皮膚塗上潤膚液作敏感測試。
- 每次用畢，必須清潔剃刀頭以保持產品日後的正常運作。
- 向左轉動電池盒外殼至O及▲接合以關閉電源。

注意：如首次轉用電動剃刀，請使用約12次以適應該種模式。不需即時定論產品效用，先讓皮膚及毛髮有足夠時間適應。

剃刀頭的清潔

本產品有防水功能，可以溫水或冷水清潔。

注意：清潔前務必先確保電源已關閉。

警告

- 請以濕布清潔產品外殼。切勿使用清潔劑或任何化學物品。
- 請以乾布拭乾產品外殼。切勿使用風筒或熱風機等。

每次用畢清潔

- 向右轉動筆頭至O與箭咀接合則可除下剃刀頭。
- 向左轉動頭套頂至O與箭咀接合則可除下剃刀套。
- 以流動清水或於洗手盆清洗刀片及刀鋼。切勿使用熱水，只可以溫水或冷水清潔。
- 清潔完畢後，讓刀片及刀鋼自然風乾後才可裝回。再將裝好的剃刀頭安裝於主機體，以乾毛巾輕抹主機體。

每月深層清潔

- 按圖A至圖E的次序拆卸。

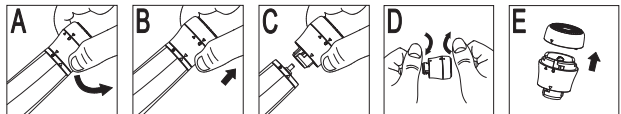

- 將內刀片保險鎖取出（圖H）。

- 取出刀片（圖I）。

- 以清水徹底清洗內外刀片的異物（圖J）。

- 與外刀片位置對應好，然後鑲回內刀片（圖K）。

- 將內刀片保險鎖放回並滑動以上鎖（圖L）。
- 將裝好的剃刀頭安裝於主機體。

比堅尼修剪器的使用

- 首次使用可以修剪梳輔助。
- 啟動開關。
- 欲完全去除毛髮或修剪出特定的比堅尼線，請使用不帶梳的修剪器。
- 脫毛時，應朝逆毛方向慢慢移動。
- 利用刀片可塑造出理想邊線。將刀片垂直置於皮膚上，沿著毛髮邊緣移動。
- 利用刀鋼可徹底去除毛髮，效果更平滑乾淨。
- 如不需徹底清除毛髮，可套上修剪梳。先將修剪梳置於刀片上，令梳齒與刀片頂併齊，向下按機背以令兩者結合（圖4）
- 向下推開以除下修剪梳（圖5）

眉毛修剪器的使用

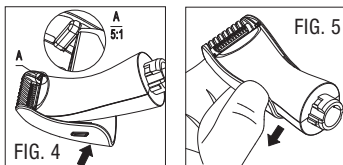

- 眉毛修剪器配備兩種刀片，大刀片用於修整身體毛髮及眉毛，小刀片用於細緻修飾。另還配有修剪梳，當不需徹底去除毛髮而只作修短時適用。修剪梳有兩面，長齒用於身體毛髮，短齒用於眉毛。
- 若留較長毛髮，將修剪梳裝於6毫米標示位置；若留較短毛髮，將修剪梳裝於3毫米標示位置（圖6）
- 安裝修剪梳時，請確保電源關閉及將修剪梳與刀片接上（圖7）

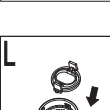
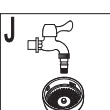
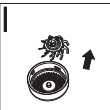

- ）。請確保梳齒與刀片向同一方向及梳頂與刀頂水平。如需徹底脫毛，則將修剪梳除下。
- 向右轉動電池盒外殼至箭咀與I標誌接合以啟動修剪器。操作完畢，則向左轉動電池盒外殼至箭咀與O標誌接合以關閉電源。
- 收藏眉毛修剪器前請先將修剪梳於刀片上除下。

修剪器刀片的保養須知

修剪器刀片只用於指定用途，使用時應小心注意。每次使用完畢，以配備的刷子掃走刀片內藏的毛髮，再以清水清洗，待自然風乾後妥善收藏以作日後使用。為確保產品耐用，請只作生產商建議之用途。

警告

- 當甩乾水時，請捉緊主機體以免產品或組件掉下。
- 切勿使用風筒或熱風機等拭乾產品。這會導致產品運作不正常或損毀。

電池安裝

- 向左轉動機體下端至三角標誌▼與▲接合，然後拉出（圖1）。
- 置入一枚AA電池。
- 將拉出的下端部分裝回機體及轉動至O與▲接合。
- 確保電池按兩極方向正確安裝（+及-）。
- 若電池電量耗盡或產品有一段時間不作使用，請將電池拆除。
- 置入電池前請先清潔電池接觸點及機體其他接觸點。
- 及時除下電池。
- 確保使用大小及等級合適的電池。

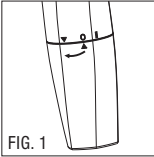

使用時切勿過度用力按，以免對皮膚造成敏感。脫毛後24小時內切勿使用香水或止汗濟等產品。

安全預防措施

警告：包裝或產品上使用的膠袋可能會造成危險。請擺放在嬰兒及兒童觸及不到的位置。



- 請勿於嬰兒床、睡床、嬰兒車或兒童玩樂範圍內使用產品。
- 膠袋的薄層可能會堵塞鼻子及口腔，阻礙呼吸。此膠袋不是玩具。
- 根據本使用說明書所述之用途使用本產品。
- 切勿把本產品放入或掉進水或其他液體中。
- 若本產品曾跌落地或有任何不妥，請馬上停止使用。

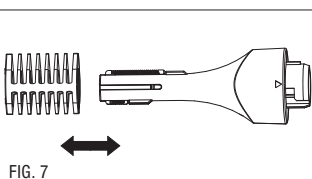
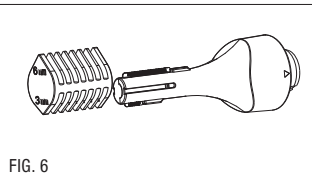

- 請不要使用非本產品提供的任何配件。
- 如刀鋼或刀齒已破裂、破損或鬆脫，切勿使用並即時更換。使用受損的刀鋼可能會引致受傷。
- 本產品不該讓有智障、殘障、感官有缺陷或缺乏使用電器經驗與常識的人士（包括兒童）單獨使用，而應由有經驗及常識之監管人監察及指導下使用此產品。兒童應被監管以保證他們不會將此產品當成玩具。
- 切勿將已接上電源或開啟的電器置之不理。
- 如若在使用中有任何不妥，請馬上停止使用及將電池除出。
- 每次用完後或清潔前請先關閉電源。
- 待電器冷卻之後才收藏。
- 當本產品處於使用狀態，不可隨意放在任何物件上。
- 該產品不應讓兒童使用、清潔或手持。將產品放於兒童觸及不到的地方。

安全棄置

為保護環境，當電池電量耗盡時，應當將電池棄置於回收箱。如果電池洩漏，注意避免皮膚接觸，並將其棄置於回收箱。

一年保養限期

在您購買日期起一年內，在正常使用的情况下，如產品的品質或零件有任何問題，美康雅顧客服務中心將會為您免費提供維修或換貨服務。

注意：此項保修不包括一切因錯誤使用、不依指示處理產品及意外損毀、遺失零件及經自行改造的產品，美康雅公司有權在不預先通知的情況下更改條款和說明書。如需獲得此保修服務，請保留正本收據，倘若產品於保養期內有任何問題，可蒞臨您所在地區的美康雅顧客服務中心處理。

保修期之後

請致電使用說明書中所列出您所在地區的美康雅顧客服務中心，詢問維修服務詳情，或是電郵至email_asia@conair.com，附上您的名字，電話號碼和電郵地址，及說明產品問題的詳細情況。

美康雅顧客服務中心

香港九龍觀塘觀塘道388號創紀之城渣打中心35樓
顧客服務熱線：(852) 2751 4604
電郵：email_asia@conair.com
網址：www.hkconair.com

C8760RGH

IB-19/146A

CONTINENTAL CONAIR LIMITED
CHINA CREATIVE DEPARTMENT

Date	1/19/22
Customer	CONAIR-HK
Model No.	C8760RGH
Description	IB
Job No.	
Reference No.	IB-19/146A
Revision No.	0
Color	1C+1C(Black)
Open Size	552mm(W) X 214mm(H)
Folded Size	92mm(W) X 214mm(H)
Material	80gsm Artpaper
Prepared by	Betty Bai
Approved by	Phoebe Laung
Vendor	Paiter
Supplier	

折疊方法
Folding method:
18 pages (9 x 2)



ALL-IN-ONE BEAUTY PEN

The TrueSmooth Beauty Pen is a must have tool for your entire bikini grooming needs to help you get bikini beautiful.

Ideal for day to day maintenance or any last minute hair removal emergencies with 3 interchangeable heads.

A rotary shaver will gently and effectively remove hair from lips, chin, cheeks and the more delicate regions, leaving a silky smooth finish.

FEATURES

- Battery operated trimmer
- Rotary shaver for a quick, close shave
- Eyebrow trimmer for precise shaping
- Precision trimmer for all over trimming
- Detail comb
- Eyebrow comb
- Storage pouch
- Shaver head cover
- For wet and dry use. Can be used in the shower
- Includes 1 x AA battery.

INSTRUCTIONS FOR USE

Preparation of the skin

Before starting: make sure that the skin is perfectly clean. Do not apply any cream or body milk.

Use on batteries

The TrueSmooth works on 1xAA alkaline battery (1.5V). To insert or replace batteries, remove the lower casing of the shaver to reveal the battery compartment. This is done by gripping the upper part of the lady shaver in one hand and pulling the lower part in a downward direction. Insert the batteries as indicated on the inside of the battery compartment (alkaline batteries ensure a better performance and a longer life for the appliance). If the appliance remains unused for a while or if the batteries are dead, remove them from the appliance. This will increase the life of the appliance.

GETTING STARTED

The TrueSmooth Beauty Pen has 3 interchangeable heads to keep your skin feeling smooth and soft.

- Make sure the unit is switched off
- Turn the head to the right, aligning the triangles ▼ and ▲.
- Switch the attachment head and put new head on, then turn to the left and align ▼ with “O”.

INSTRUCTIONS FOR USE

- Twist battery cover to the left to unlock battery cover
- Insert 1 x AA battery according to the polarity marking, return the battery cover, turn to the right and align with “O” and ▲ marks to lock, and then twist to the right again. The unit will start to work when the «I» and ▲ marks are aligned.
- After use, turn off the power by making the ▲ of the battery

cover align with “O” mark.

BEFORE USE

- Test one small section of the leg or arm before using any of the attachments on the rest of the body.
- If any sensitivity or allergic reactions occur, discontinue use immediately.
- Do not use on sensitive or irritated skin

USING THE ROTARY SHAVER

Never use a foil that is damaged, as this can result in injury. This appliance is suitable for dry and wet shaving.

SHAVING

- Attach the shaver head.
- Twist the battery cover to the right and align “I” and ▲ marks to start the unit.
- Hold the shaving foil against the skin, moving the shaver slowly and smoothly in circular motions against the grain of your natural hair growth.

- Don’t push too hard against the skin as this will cause irritation and may damage the foil.
- As your skin may be sensitive after shaving, test your moisturizer on a small patch of skin and wait to see if irritation occurs.
- Cleaning: After each use, you will need to clean the shaver head to ensure continued performance.
- Twist the battery cover to the left and align “O” and ▲ marks to turn the unit off.

NOTE: If you are switching to an electric or battery-operated shaver for the first time, it will take 12 uses for your skin and hair to adjust to this new method of removing hair. Do not evaluate performance until you have allowed your skin and hair time to adjust.

HOW TO CLEAN YOUR SHAVER HEAD

This is a water-proof appliance. The appliance may be cleaned under warm or cold water.

NOTE: When cleaning your unit, make sure the unit is turned off.

CAUTION

- To clean the external surfaces of the appliance, use a damp cloth. Do not use strong detergents or other chemicals.
- To dry, wipe the surface of the appliance with a dry towel. Do not use a hair dryer or heater to dry the appliance.

CLEANING AFTER EVERY USE:

- To take the shaver head off, twist the top of the head from “O” to the right and align the arrows to remove
- To take the shaver cover off, twist the top cover of the head from “O” to the left and align the arrows to remove.
- Rinse the shaver cutter and foil frame under running water or in a sink. Do not use hot water. Use only warm or cold water.

- After wet cleaning, allow the foil frame and cutters to air-dry before closing foil frame and shaver head. Replace shaver head back onto the main unit until it clicks into place. Wipe the surface of the main unit with a dry towel.

DEEPLY CLEANING EVERY MONTH:

- Perform the cleaning steps FIG. A to FIG. E.

- Remove the inner cutter lock away from the cutters (see FIG. H).

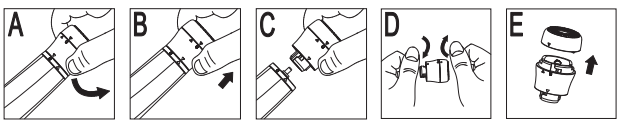

- Remove the cutters (see FIG. I).

- Thoroughly rinse away any debris from inner and outer cutters (see FIG. J).

- Replace the inner cutters by matching the inner cutters to the corresponding outer cutter hub (see FIG. K).

- Place inner cutter lock back into position by sliding it back into the support until it snaps into place (see FIG. L).

- Snap shaver head assembly back onto main unit.

USING THE BIKINI TRIMMER

- Start with the guide comb attached for first-time use.
- Turn the unit on.

- To clean the external surfaces of the appliance, use a damp cloth. Do not use strong detergents or other chemicals.
- When removing hair, gently move the blades against the direction of growth.
- To outline, place the blades perpendicular to the skin surface and apply the blades to the edge of the hair. Use the blades to create the desired outline.
- For the cleanest finish, follow up with the foil shaver.
- For cutting hair without completely removing it, attach the detail comb to the head. Place the comb on the cutting blades first, align the comb ribs with top surface of trimmer head housing and then snap down onto the back of the

trimming head (see FIG. 4).

- Snap off the comb guide to release from the trimmer head (see FIG. 5).

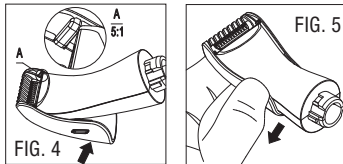

USING THE EYEBROW TRIMMER

- This trimmer comes with two trimming blades. The larger blade can be used to trim body hair and eyebrows. The smaller blade is ideal for detailing. It also comes with a comb attachment that helps you achieve an even cut when you do not want to completely remove the hair. The comb attachment has two sides: The long tooth is for body hair, and the short tooth is for eyebrow trimming.
- Aligning the indicator with the 6mm mark on the comb leaves hair longer, while aligning with the 3mm mark leaves hair shorter (see FIG. 6).
- To use the comb attachment, be sure the unit is in the OFF position and slide the comb over the trimming blades (see FIG. 7). Make sure that the teeth of the comb are facing in the same direction as the trimming blade, and that the top of the comb is even with the top of the trimmer. If you want to completely remove hair, use the trimmer without the comb attachment.
- To operate the trimmer, turn the battery cover to the right so arrow points to the “I” mark. When finished trimming, turn the unit off by turning the battery cover to the left, so arrow points to “O” mark.
- To store the trimmer, slide the comb attachment cover over the trimming blades.

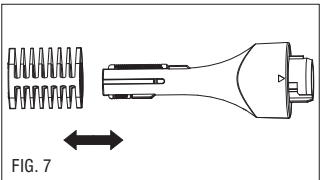
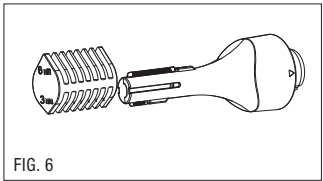

Caution

- When shaking off excess water, hold the main unit firmly to prevent releasing the head assembly or dropping the unit.
- Do not use a dryer or heater to dry the trimmer. This may result in malfunction or damage to the trimmer.

BATTERY INSTALLATION:

- Twist bottom housing of unit to the left and align triangles ▼ and ▲ and pull (see FIG. 1).
- Insert 1 AA battery.
- Slide bottom housing back in place and align “0” and ▲.
- Ensure the battery is installed correctly with regard to polarity (+ and -).
- Remove the battery if it is no longer functional or if the trimmer is left unused for an extended period of time.
- Clean the battery contacts and also those of the device prior to battery installation.
- Remove used battery promptly.
- Always purchase the correct size and grade of battery most suitable for its intended use.

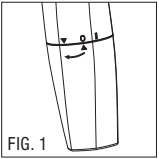

Do not apply too much pressure to avoid causing irritation to the skin.
Do not apply any perfume or deodorant for 24 hours after shaving.

SAFETY PRECAUTIONS

WARNING: The polyethylene bags over the product or its packaging may be dangerous. Keep these bags out of the reach of babies and children.



Never use them in cribs, children's beds, pushchairs or playpens. The thin film may cling to the nose and mouth and prevent breathing. A bag is not a toy.

1. Use this appliance only for its intended use as described within this instruction booklet.
2. Never immerse the unit in water or any other liquid.
3. Do not use the unit if it has fallen or if it appears to be damaged.
4. Do not use any accessories other than those recommended by manufacturer.
5. If the foil or teeth is cracked, broken or loose, do not use it again and replace with a new foil.using a foil in a faulty condition can cause injury.
6. This unit is not intended for use by people (including children) with reduced physical, sensory or mental capabilities, or by persons who lack experience or knowledge, unless they are supervised or have been given instructions beforehand on the use of the unit by a person responsible for their safety. Children should be supervised to make sure they do not treat the unit like a toy.
7. Do not leave the unit unattended when switched on.
8. Please stop using it immediately and remove batteries if you have problems when using it.

9. Switch off the unit after each use and before cleaning it.
10. Allow the unit to cool before storing.
11. Do not place the appliance on any surface whilst in operation.
12. This appliance should not be used, cleaned or maintained by children. Keep out of reach of children.

SAFE DISPOSAL

When the batteries have run down, they should be disposed of at a recycling centre to safeguard the environment, If the batteries leak avoid touching them and dispose of them at a recycling centre.

Never dispose of batteries in fire, except under condition of controlled incineration. Failure to observe this precaution may result in an explosion. Never attempt to recharge primary batteries, as this may cause leakage, fire, or explosion.

ONE YEAR LIMITED WARRANTY

This Conair Appliance is guaranteed for consumer use for one year. To obtain this warranty service, please keep the original purchase receipt. This guarantee is no longer valid in case of alteration or repair by any unauthorized persons and only covers defects under normal use from the date of purchase. If your product does not perform satisfactorily because of defects in materials or manufacture, it will be repaired or replaced under guarantee through the Conair Service Centre. Conair reserves the right to amend terms and specifications without prior notice.

OUT OF GUARANTEE

Call Conair Service Centre in your region as listed in this Instruction Booklet for details of repair service. Or email to us at email_asia@conair.com with your name, contact telephone number and email address and details of the fault.

CONAIR CUSTOMER SERVICE:

35/F., Standard Chartered Tower, Millennium City,
388 Kwun Tong Road, Kwun Tong, Kowloon, Hong Kong
Conair Customer Hotline: (852) 2751 4604
E-mail: email_asia@conair.com
Website: www.hkconair.com